



Voorhees Township
 2400 Voorhees Town Center
 Voorhees, NJ 08043
 (856) 429-0647

Date Issued: 1/9/2024
 Application Number: Z-24-017
 Application Date: 1/8/2024
 Project Number: _____
 Permit Number: Z-24-014
 Fee: \$60.00

Zoning Permit

Worksite **73 WM FEATHER DR**
 Location: **Voorhees, NJ 08043**

Block: **229.10**
 Lot: **8**
 Qualifier: _____

Zone: **RD2**

Owner: **MISHRA, AMITKUMAR**
 Address: **73 WILLIAM FEATHER DR**
VOORHEES, NJ 08043

Applicant: **Dan Mitchell**
 Address: _____
, NJ

Application Approved Date: 1/9/2024

This Certifies that an application for the issuance of a Zoning Permit has been examined.

Use is: MDR-RD2
 Nonconforming Use is: _____

Work Description:

Deck/Porch - Construction of a 12' x 20' deck at rear of home, as per submitted plan.

Upon review it was determined that the Zoning Permit:

- Permitted by Ordinance
- Permitted by Variance approved on: _____
- Valid Nonconforming Use is established by
 - Zoning Board of Adjustment
 - Zoning Officer

Bradley _____

1/9/2024
 Date

Z-24-014
1/9/24

Voorhees Planning & Zoning Department
2400 Voorhees Town Center
Voorhees, NJ 08043



Hours: 8:30 am - 4:30 pm, M-F
Phone: 856-429-0647
Fax: 856-795-2335

ZONING PERMIT APPLICATION

\$60 Permit Application Fee, Due Upon Submission
(\$20 Resubmission Fee, Due Upon Resubmission)

Property Owner: Amitkumar Mishra Date of Application Submission: Manisha Mishra

Property Address: 73 William Feather Dr. Voorhees NJ 08043

Block: _____ Lot: _____ Qual: _____ Name of Development: _____

Owner Email: amitmishra.sap@gmail.com Owner Phone Number: 8328752056

Contractor Name: Dan Mitchell Contractor Address: 421 Cleveland ave Lindenwold NJ 08043

Site Supervisor: _____ Contractor City, State & ZIP: _____

Contractor Phone: 609 634 8569 Contractor Email: Daniel Mitch 91@gmail.com

NOTE: If this property is subject to a community association (HOA) which requires their approval, that approval must be sought from the association separately. The issuance of a Zoning Permit does not replace or negate a property owner's responsibility or requirement to obtain their association's approval.

REQUIRED: Email where approval is to be sent: Daniel Mitchell 91@gmail.com

REQUIRED: Proposed use/structure/improvement (please describe in detail): Current step removal + Deck build 20 x 12

Please complete all applicable fields:

Floor area (in square feet): 240 Structure/Fence Height (in feet): _____

Front Setback: _____ Rear Setback: 70 ft Side Setback: 20 ft

Side/Secondary Front Setback: _____ Lake Setback: _____

Lot Area (in square feet): _____ Corner Lot? Yes or No No

For New Garage Only

Front Entrance (in feet): _____ Side Entrance (in feet): _____

Number of Cars: _____ Floor Area (in square feet): 3278

Lot Coverage (SF and % of lot area): _____ Off-Street Parking Spaces: _____

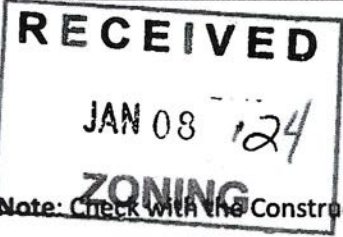

[Signature]

Signature of Applicant

Note: Check with the Construction Department for Construction Permit application requirements and procedures.

ZONING OFFICE USE ONLY		
Date Paid: <u>1/8/24</u>	<u>\$0</u> Check #:	Collected by: <u>[Signature]</u>

DER AND SUBJECT TO ALL CONDITIONS, RESTRICTIONS AND EASEMENTS OF RECORD, WHERE
BLE MERIDIAN-DEED BASE TAX MAP BASE PLAN BASE FORMER SURVEY BASE

EBAR/IRON PIPE SET

CONCRETE MONUMENT SET

DESCRIPTION: BEING KNOWN AS LOT 8, BLOCK 229.10 ON
THE OFFICIAL TAX MAP.

AREA=17134.1±S.F.

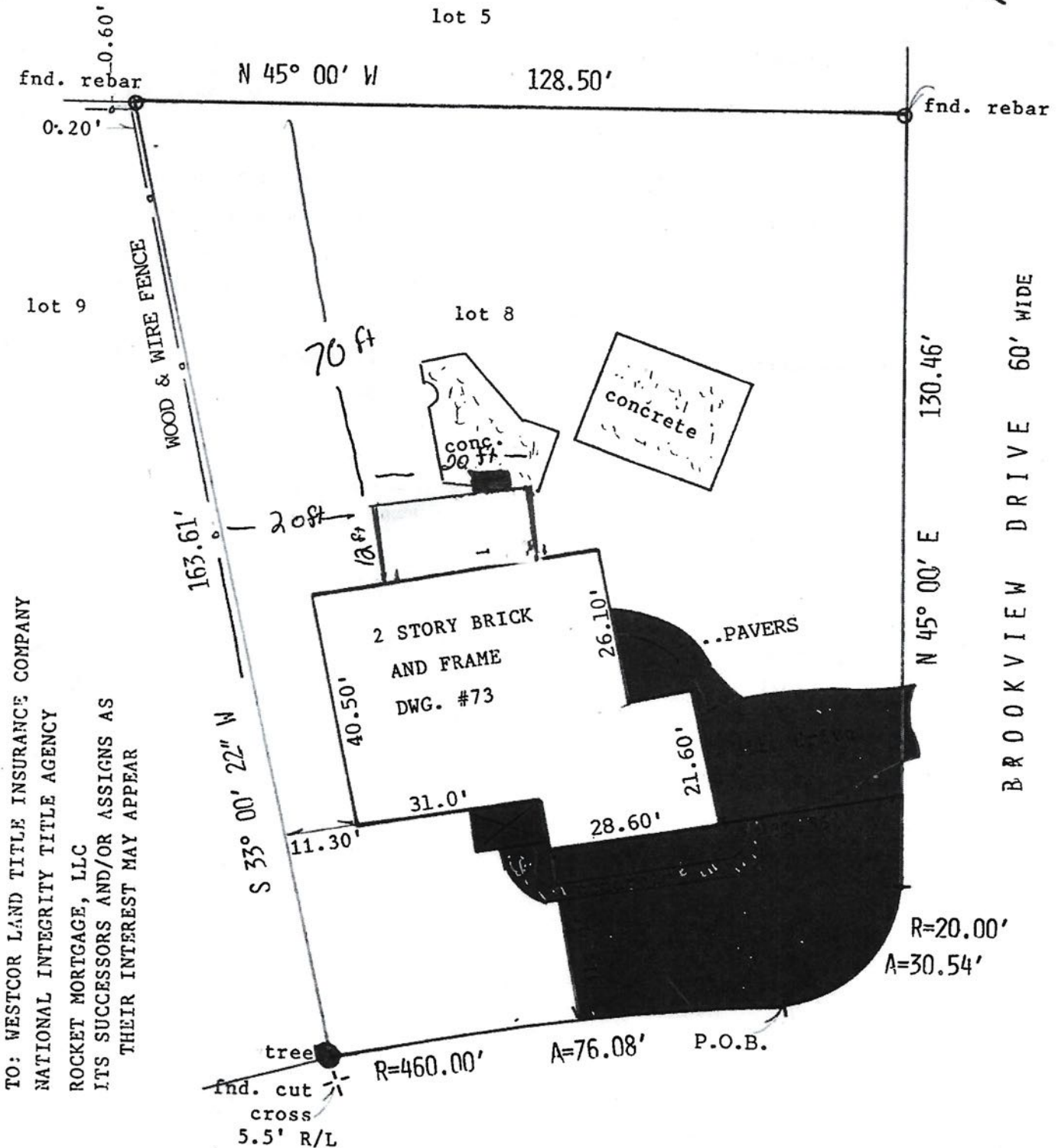

TO: WESTCOR LAND TITLE INSURANCE COMPANY
NATIONAL INTEGRITY TITLE AGENCY
ROCKET MORTGAGE, LLC
ITS SUCCESSORS AND/OR ASSIGNS AS
THEIR INTEREST MAY APPEAR

inspections@voorheesnj.com



Date Issued
Control #
Permit #

24-0207

CONSTRUCTION PERMIT NOTICE

Block 229.10 Lot 8 Qualification Code _____
Work Site Location: 73 WM FEATHER DR.

AUTHORIZED FOR:

- BUILDING
- PLUMBING
- ELEVATOR DEVICES
- OTHER

RECEIVED
ELECTRICAL
MAR 05 2024
FIRE PROTECTION
VOORHEES TOWNSHIP
PERMITTING DEPARTMENT
DEMOLITION

Description of Work: DECK

This notice shall be posted conspicuously at the work site and shall remain so until issuance of a certificate.

**N.J. DIVISION OF
CONSUMER AFFAIRS RULE:
N.J.A.C. 13:45A - 16.2(a)10.ii**

FOR INSPECTION ON CONSTRUCTION PERMITS FOR:

**BUILDING
ELECTRIC
PLUMBING
FIRE PROTECTION
OR
ELEVATOR**

**FINAL PAYMENT TO THE CONTRACTOR
IS NOT REQUIRED TO BE MADE
BEFORE A FINAL INSPECTION
IS PERFORMED.**



CONSTRUCTION PERMIT

Date Issued 3/5/2024
 Control # C-24-00224
 Permit # 24-0207

IDENTIFICATION Block: 229.10 Lot: 8 Qualifier _____
 Work Site Location: 73 WM FEATHER DR Voorhees, NJ 08043 Contractor MITCHELL CONTRATING
 Address 421 CLEVELAND AVE LINDENWOLD NJ 08021
 Owner in Fee MISHRA, AMITKUMAR
73 WILLIAM FEATHER DR VOORHEES NJ 08043 Telephone: (856) 506-0621
 Telephone: (832) 875-2056 Lic. No. or Bldrs. Reg. No. _____
 Federal Employee. No. _____

Is hereby granted permission to perform the following work:

- BUILDING PLUMBING LEAD HAZARD ABATEMENT
 ELECTRICAL FIRE PROTECTION DEMOLITION
 ELEVATOR DEVICES ASBESTOS ABATEMENT (Subchapter 8 only) OTHER

DESCRIPTION OF WORK:

Deck - DECK 12*20

Note: If construction does not commence within one (1) year of date of issuance, or if construction ceases for a period of six (6) months, this permit is void.
 Estimated Cost of Work \$20,000

 Robert Gates, Construction Official
 Construction Official

3/5/2024
 Date

U.C.C. F170
 equiv (rev 1/04)

- 1 WHITE - INSPECTOR 2 CANARY - OFFICE 3 PINK - TAX ASSESSOR 4 GOLD - APPLICANT

PAYMENTS (Office Use Only)	
Building	\$720
Electrical	\$0
Plumbing	\$0
Fire Protection	\$0
Elevator Devices	\$0
Other	\$0.00
DCA Training Fee	\$38
CO Fee	
Other	\$0
Total	\$758
Check No.	370
Cash	\$0
Credit	\$0
Collected By	Counter Computer

REQUIRED INSPECTIONS

Construction work must be inspected in accordance with the State Uniform Construction Code Regulations N.J.A.C. 5:23-2.18. This agency will carry out such periodic inspections during the progress of work as are necessary to insure that the work installed conforms with the requirements of the Uniform Construction Code.

The owner or other responsible person in charge of work must notify this agency when work is ready for any required inspections specified below. Requests for inspections must be made at least 24 hours prior to the time the inspection is desired. Inspections will be performed within three business days of the time for which they are requested. The work must not proceed in a manner which will preclude the inspection until it has been made and approval granted.

- Required inspections for all subcodes for one- and two-family dwellings are as follows:
1. The bottom of footing trenches before placement of footings, except that in cases of pile foundations, inspections shall be made in accordance with the requirements of the building subcode.
 2. Foundations and all walls up to grade level prior to back filling.
 3. All structural framing, connections, wall and roof sheathing and insulation; electrical rough wiring, panel and service installation; rough plumbing. The framing inspection shall take place after the rough electrical and plumbing inspections and after the installation of the heating, ventilation and/or air conditioning duct system. The insulation inspection shall be performed after all other subcode rough inspections and prior to the installation of any interior finish material.
 4. Installation of all finished materials, sealings of exterior joints, plumbing piping, trim and fixtures; electrical wiring, devices and fixtures; mechanical systems equipment.

Additional required inspections for all subcodes of construction, for other than one- and two-family dwellings, are fire suppression systems, heat producing devices and Barrier Free subcode accessibility, if applicable.

- Required special inspections. The applicant by accepting the permit will be deemed to have consented to these requirements:
- A final inspection is required for each applicable subcode area before a final Certificate of Occupancy or Approval may be issued. The final inspections include the installation of all interior and exterior finish materials, sealing of exterior joints, mechanical system and other required equipment; electrical wiring, devices and fixtures; plumbing pipes, trim and fixtures; tests required by any provision of the adopted subcodes, Barrier Free accessibility, if applicable; and verification of compliance with NJAC 5:23-3.5, "Posting structures".
- A complete copy of released plans must be kept on the job site.

If you do not understand any of this information, please ask.



BUILDING SUBCODE TECHNICAL SECTION



Date Received 2/12/2024
 Control # C-24-00224
 Date Issued 3/5/2024
 Permit # 24-0207

A. IDENTIFICATION - APPLICANT: COMPLETE ALL APPLICABLE INFORMATION. WHEN CHANGING CONTRACTORS, NOTIFY THIS OFFICE. CALL UTILITY DIG NO: 1-800-272-1000
 Block 229.10 Lot 8 Qualification Code _____
 Work Site Location: 73 WMI FEATHER DR Voorhees, NJ 08043

Owner in Fee: MISHRA, AMITKUMAR
 Address 73 WILLIAM FEATHER DR VOORHEES NJ 08043
 Tel. (832) 875-2056 Email _____
 Contractor: MITCHELL CONTRACTING
 Address 421 CLEVELAND AVE LINDENWOLD NJ 08021 Email danielmitch91@gmail.com

Tel. (856) 506-0621 Fax (856) 205-0884
 Contractor License No. or, if new home, Bldrs Reg. No. _____ Exp. _____
 Home Improvement Contractor Registration No. or Exemption Reason(s) applicable): _____
 Federal Emp. ID No. 92-221784449

JOB SUMMARY (Office Use Only)

PLAN REVIEW Date Initial
 No Plan Required _____
 All 2/29/2024 **KB**

Footing/Foundation _____
 Struct/Framework _____
 Exterior _____
 Interior _____
 Joint Plan Review Required _____
 Elec. Plumb. Fire Elevator _____
 SUBCODE APPROVAL for PERMIT _____
 Date: 2/29/2024
 Approved by: kbagnell
 SUBCODE APPROVAL for CERTIFICATE
 CO CCO CA
 Date: _____
 Approved by: _____

INSPECTIONS	Type:	Failure	Dates (Month/Day)	
			Failure Approval	Initial
Footing Bonding				
Foundation				
Slab				
Frame				
Truss Sys./Bracing				
Barrier-Free				
Insulation				
Finishes-Base Layer				
Finishes-Final				
Energy				
Mechanical				
TCO				
Other				
Final				
Barrier-Free				

B. BUILDING CHARACTERISTICS

Use Group Present _____ Proposed R-5 If Industrial Building: _____
 Constr. Class Present _____ Proposed _____ State Approved _____
 HUD _____

Number of Stories _____
 Height of Structure _____ Ft.
 Area - Largest Floor _____ Sq. Ft.
 New Bldg. Area / All Floors _____ Sq. Ft.
 Volume of New Structure _____ Cu. Ft.
 Total Land Area Disturbed _____ Sq. Ft.

C. CERTIFICATION IN LIEU OF OATH

I hereby certify that I am the (agent of) owner of the record and am authorized to make this application.

Signature _____
 Print Name Here: _____

D. TECHNICAL SITE DATA

DESCRIPTION OF WORK
Deck, - DECK 12*20

TYPE OF WORK

New Building _____
 Addition _____
 Rehabilitation \$720
 Roofing _____
 Siding _____
 Fence _____ Height (exceeds 6') _____
 Sign _____ Sq. Ft. _____
 Pool _____
 Retaining Wall _____ Sq. Ft. _____
 Asbestos Abatement Subchapter 8 _____
 Lead Haz Abatement NJAC 5:17 _____
 Radon Remediation _____
 Other _____
 Demolition _____

FEE (Office Use Only)

Administrative Surcharge	_____
Minimum Fee	_____
State Permit Surcharge Fee	<u>\$38</u>
TOTAL FEE	<u>\$758</u>



Voorhees Township

Payment PMT-24-1753 with Fee Items

Tracking	Date	Cash	Charge	Check	Check #	Account	Receiver	
PMT-24-1753	3/5/2024	0	0	758	370	C-24-00224 - 73 WM FEATHER DR Alteration Deck - DECK 12*20	Counter Computer	
							Balance	Paid
DCA Fee	#DEFAULT DCA FEE ACCOUNT	73 WM FEATHER DR Voorhees NJ 08043		24-0207			0	38
Building Fee	#DEFAULT BUILDING FEE ACCOUNT	73 WM FEATHER DR Voorhees NJ 08043		24-0207			0	720
							0	758
1 Payments		Cash Total	Charge Total	Check Total	Total		Balance	Paid Total
2 Fee Items		\$0.00	\$0.00	\$758.00	\$758.00		\$0.00	\$758.00
Totals by Department								
Construction	Fee Total	Paid Total	Zoning Board	Fee Total	Paid Total	Pet	Fee Total	Paid Total
Engineering	\$0.00	\$0.00	Planning Board	\$0.00	\$0.00	Fire Prevention	\$0.00	\$0.00
Public Works	\$0.00	\$0.00	Land Use	\$0.00	\$0.00			
Health Pro	\$0.00	\$0.00	Code Enforcement	\$0.00	\$0.00			

Cross Section

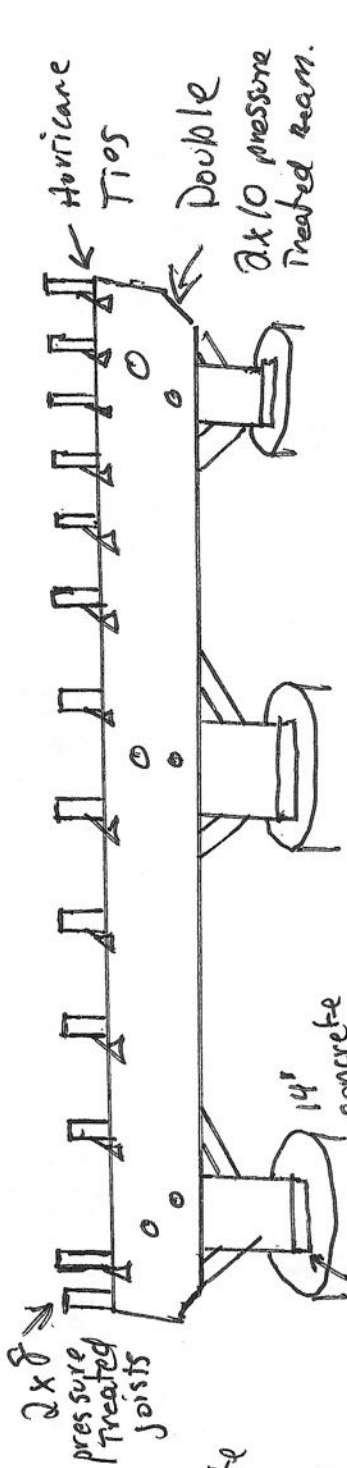
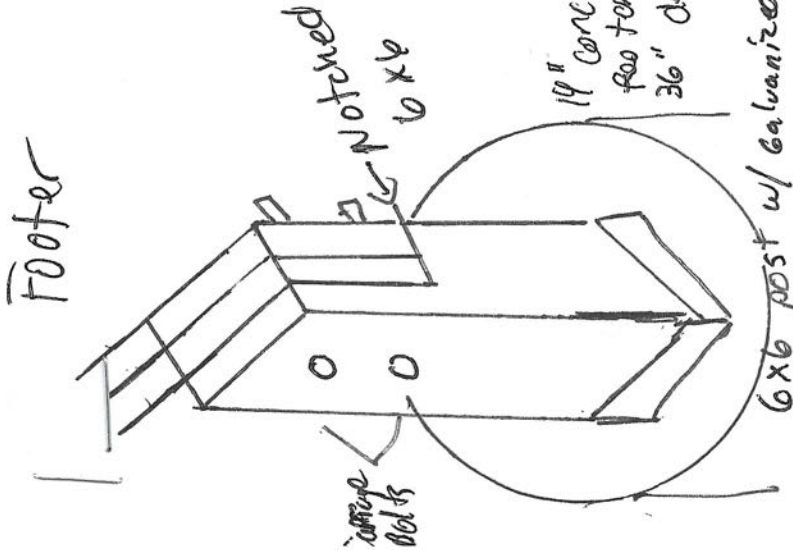

4 galvanized nails 16" apart
 To connect Beam Together

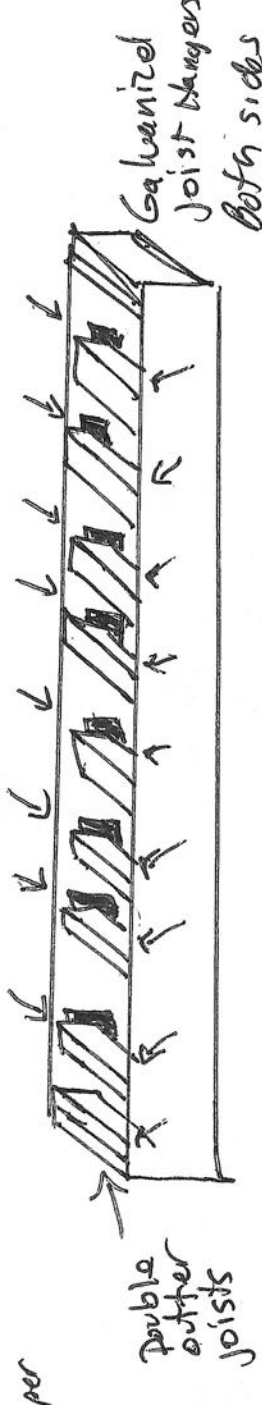

Railing Post

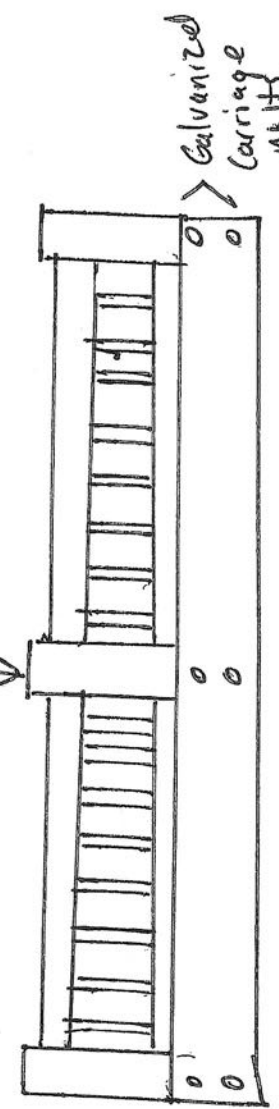

4x4 pressure Treated Railing
 4x4 pressure Treated Railing
 Anstr

VOORHEES TOWNSHIP
 PLAN RELEASE
 NAME: _____ DATE: 2-22-24
 BLD SUB CODE _____
 PLB SUB CODE _____
 ELEC SUB CODE _____
 FIRE SUB CODE _____
 CONST OFFICIAL _____
FIELD COPY



Step Plans.

Outer Double Joist

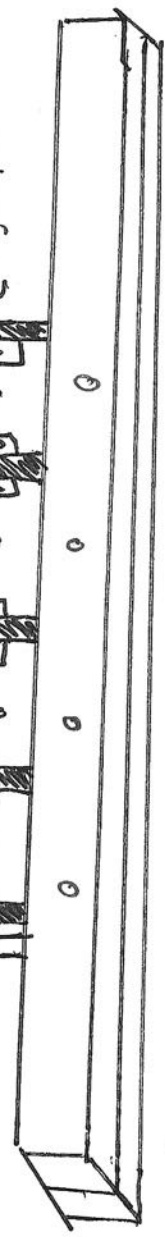

Stringers →

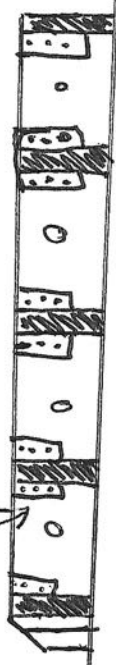

7 1/4 inch Rise on steps

10 inch Run.

48" wide Steps

Double 2x8 pressure treated secured w/ Curving Bolts to Double 2x12 pressure treated Stringers.

Secured w/ galvanized joist hangers

existing Concrete Step Base →

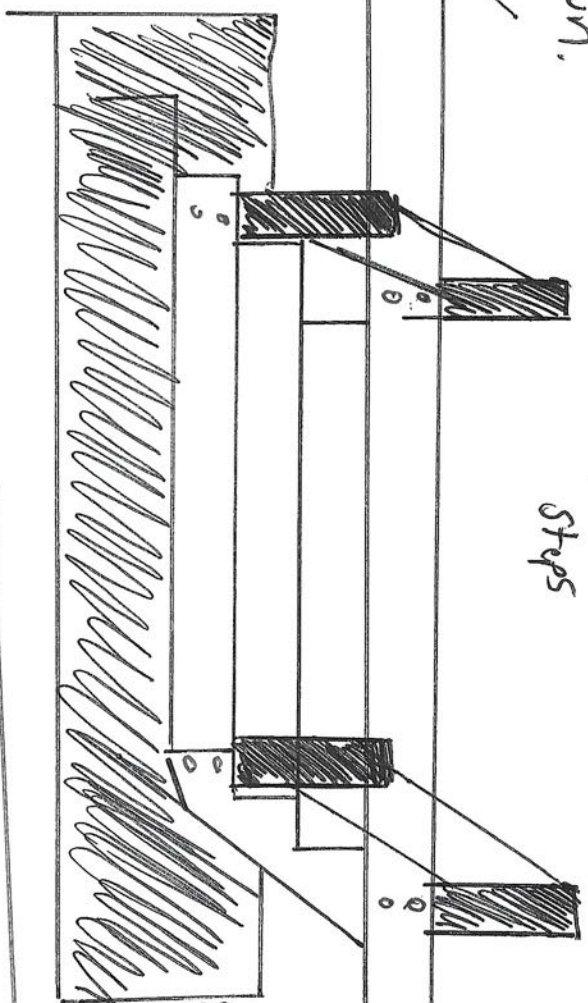

4x4 Railing posts Solid 2x8 front kick plates across stringers

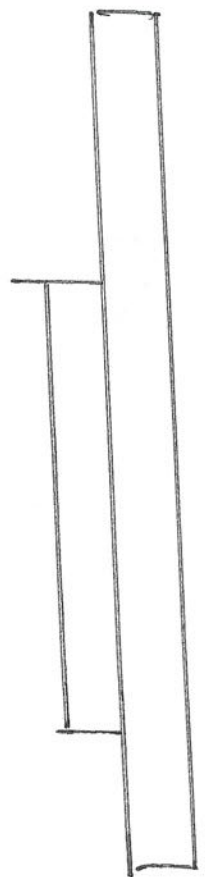

House

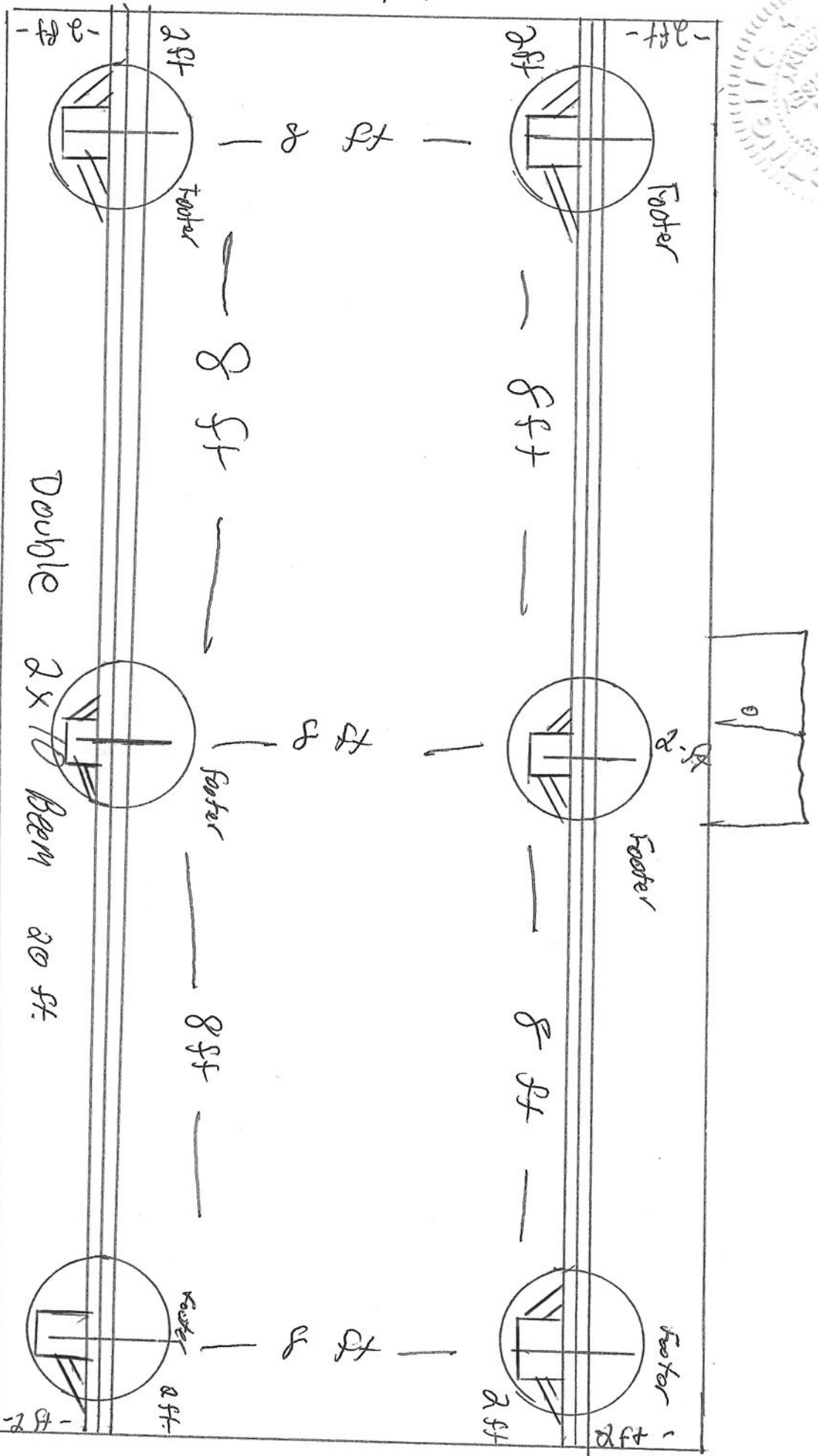

12 ft

6x6 galvanized base
Post

Footers

Beams - Double
2x10 pressure treated
Footers - 3 ft deep 14" wide
Posts - 4x4 Accr. no